

# SEPHRA®

CATERING EQUIPMENT AND SUPPLIES

## 8oz POPCORN MACHINE OPERATING MANUAL

VERSION 2.0.3 SEPTEMBER 2024

Sephra Europe are your one-stop shop for Popcorn Machines, Consumables, Spare Parts and Repairs.



# TABLE OF CONTENTS

3	TABLE OF CONTENTS
4	IMPORTANT SAFEGUARDS
5	THE LEGEND OF SEPHRA
6	DEAR SEPHRA
7	UNPACKING YOUR MACHINE
9	ASSEMBLY PROCEDURE
13	USING YOUR POPCORN MACHINE
14	MAINTENANCE & CLEANING

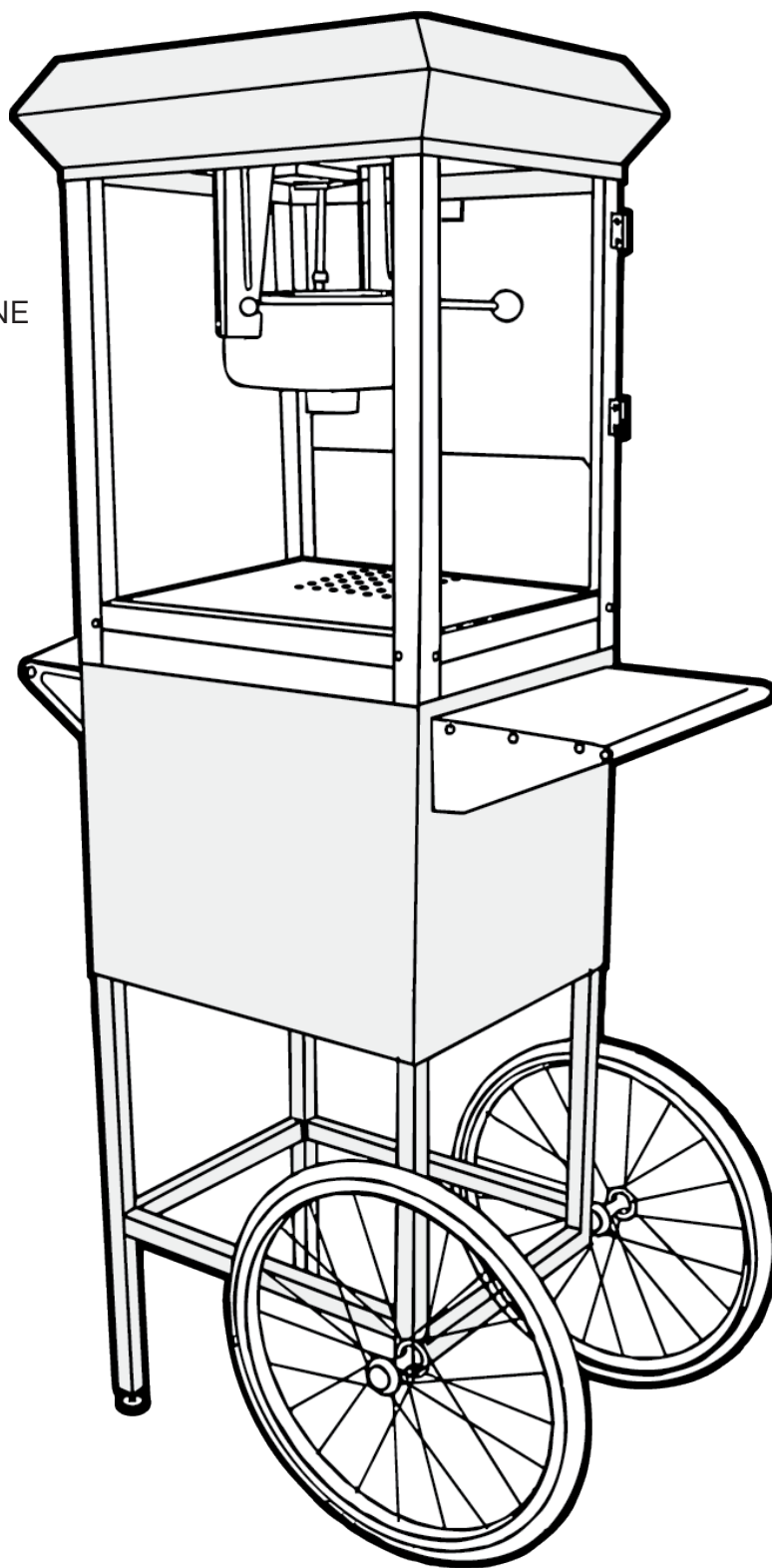

# IMPORTANT SAFEGUARDS

Read all the instructions before using your Popcorn Machine.

1. **EXTREME CAUTION** must be used when emptying the Kettle after popping action stops... a heat resistant glove or mitt is highly recommended. The Kettle can reach temperatures up to 475°F
2. **DO NOT** touch hot surfaces. Touching the Kettle directly will result in burns. Always use handles to operate.
3. Keep loose clothing and other flammable items away from the hot Kettle to avoid melting, combustion or burns.
4. Keep plastic bags or other containers not recommended for use away from hot Kettles to avoid melting, combustion or burns.
5. **STEAM IS HOT!** It is **NOT** recommended that you open the lids of the Kettle when in use or when hot. Escaping steam can **BURN**. Use only the Kettle handle to tilt the Kettle to extract any hot contents.
6. **DO NOT** use this appliance for anything other than the indicated usage. This Popcorn Popcorn Machine is intended for residential or personal use only.
7. The Popcorn Machine must be properly assembled before using it. Follow instructions and recommendations carefully.
8. **ONLY** connect to an electrical outlet with the correct electrical supply and proper grounding to reduce the risk of shock and fire. **DO NOT** cut or remove the grounding pin. If you do not have a three-prong electric receptacle outlet available, have a certified electrician install a proper outlet. **DO NOT** use a wall receptacle that is not properly grounded. Consult a qualified electrician to make sure your wiring and circuit can handle the electrical load required to operate this appliance.
9. Make sure **ALL** switches are in the "**OFF**" position after each use, disconnect power cord from the electric outlet before cleaning.
10. **DO NOT** immerse cord or plug into water or other liquids. **DO NOT** use extension cords or adapters to connect the unit to an electrical power source.
11. **DO NOT** operate the appliance with damaged cord or plug, malfunction or with any mechanical damages.
12. **ALWAYS** wear safety glasses when servicing this Popcorn Machine.
13. **DO NOT** move the Popcorn Machine during operation. Allow hot parts to cool down before moving or handling.
14. **DO NOT** add kernels into a dry pot (without oil). To avoid overheating, always have oil and kernels ready before turning on heat.
15. **DO NOT** place Kettle into a dishwasher. **DO NOT** immerse Kettle into water.
16. **DO NOT** place the unit on or near a gas or electric burner or near a heated oven.
17. **DO NOT** use outdoors, in wet environments or near a swimming pool, pond or hot tub/Jacuzzi.
18. **DO NOT** use accessories or attachments that are not provided or recommended by manufacturer.
19. **KEEP CHILDREN** well away from Popcorn Machine while in operation..
20. **DO NOT** use abrasive cleaning products or abrasive cloth or materials on any surface of this machine. Mild synthetic abrasive cloth may be used on inside of pot. **Absolutely NO Steel Wool.**
21. **NEVER** force any parts or brackets into position.

Please make sure that you save these instructions whether for you intend to use the appliance for Domestic or Commercial purposes.

# THE LEGEND OF SEPHRA

Woven among the threads of ancient Aztec legend lies the story of Sephra, an enchanting goddess whose beauty could be described only as the richness of the dark earth combined with the lustre and glow of pure gold. Her voice was softer than the most delicate flower, and her presence carried the aroma of sweet cocoa. It was Sephra who gave the ancient Aztecs the precious gift of the cocoa tree.

The legend reveals that the spirit of Sephra nourished the cocoa trees and lived within the priceless beans they produced. The Aztec kings named the cocoa tree “Theobroma Cacao,” meaning “food of the gods.” So valuable were cocoa beans that they were used to pay tribute to royalty and were given as sacred offerings to the gods.

Montezuma, the ruler of the wealthy Aztec Empire, was so enchanted by Sephra that he commissioned an elite force of skilled artisans and master craftsmen to construct a temple in her honour. As a special offering to the goddess, Montezuma built a magnificent fountain in the highest room of the temple and filled it with glistening spring water, which flowed from beneath its walls. He then surrounded the fountain with a splendid array of the most perfect cocoa beans, in hopes that Sephra would continue to bless the people with the unique and valuable crop.

So pleased was Sephra with Montezuma’s gift that she came to him in a dream and told him that her spirit would always live in the fountain he had given her. Moments later, Montezuma awoke to the sweet smell of cocoa lingering in the air. The aroma led him to the upper room of the temple where Sephra’s fountain stood.

To his astonishment, the fountain no longer flowed with water, but with the richest, purest chocolate... this was truly a gift from the gods.

For centuries, Sephra’s fountain remained hidden beneath the ruins of the ancient Aztec temple, waiting to be discovered. At long last it was, and with it was unveiled the secret of the pure, rich chocolate once coveted by gods and kings . . .

© Sephra



# DEAR SEPHRA CUSTOMER

Thankyou for choosing one of our appliances. It is very easy to use and we do strongly recommend that you carefully read these instructions which include advice on how to use and install your appliance in order to obtain optimum results.

## RECEPTION AND UNPACKING

Any product damage due to transport must be reported to the carrier by registered letter with acknowledgement of receipt within 24 hours of receiving your appliance.

You must also note your observations on the delivery note, describing in detail the damage noticed on delivery.

## ORDERING AND CONTACTING US

You can order all you need for your appliance by contacting us on +44 (0)1592 656 737.

Purchase online by visiting our company website: <http://www.sephra.com>.

Any direct queries can be sent to: [info@sephra.com](mailto:info@sephra.com)

Our mission is to help you make your Sephra appliance a very profitable aspect of your business and we look forward to assisting you.

Thankyou for choosing Sephra!

The Sephra team

# UNPACKING YOUR MACHINE

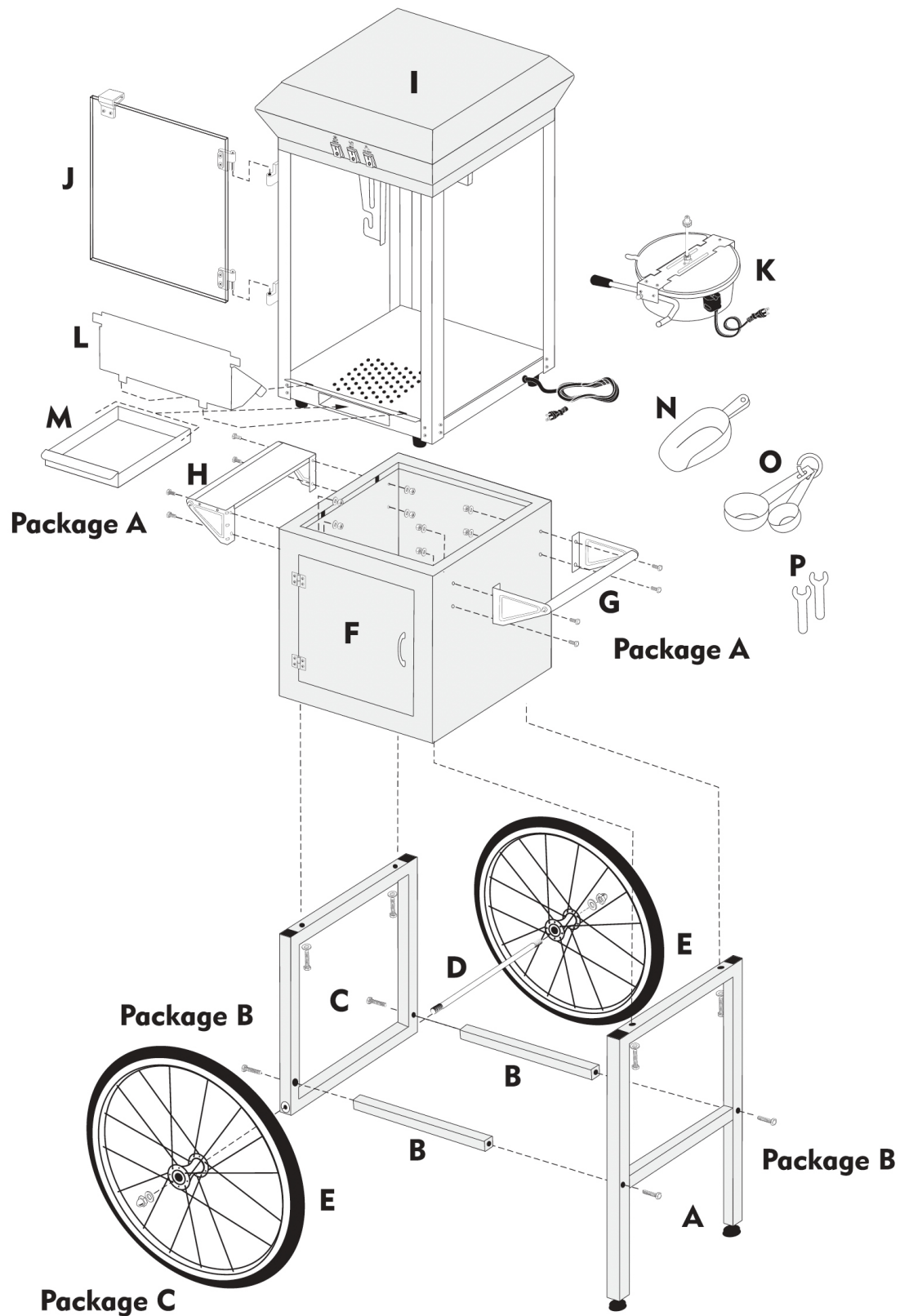

# UNPACKING YOUR MACHINE

Unpacking the shipping crate that holds your new Popcorn Machine is the most exciting moment for a true Popcorn aficionado like yourself. Upon removing anything from the carton, inspect the parts for damage. Photograph any damage that may have occurred to the outside of the carton. Photograph any damage to the Popcorn Machine.

Compare the parts in the carton to the list on the following pages. If you find that the carton is missing a part contact [info@sephra.com](mailto:info@sephra.com) or call us on +44 (0)1592 656 737.

## PARTS LIST

A. Long Stand  
B. Square Cross Members x 2 pc. C. Short Wheel base  
D. Axle  
E. Wheels x 2 pc..  
F. Storage cabinet  
G. Hand Rail  
H. Work Platform  
I. Popcorn Machine Cabinet J. Popcorn Machine Cabinet Door  
K. Kettle  
L. Front Tilt Door  
M. Old Maids Drawer  
N. Popcorn scoop  
O. measure cup set  
P. Assembly Wrench Set 9/16" / 14mm

**Package A:** 9/16"x 1/2" bolts, nuts, washers - 8 pcs. each

**Package B:** 9/16"x1-3/8" bolts x 8 pcs., washers x 4 pcs.

**Package C:** 9/16", Cap Nuts, washers x 2 pcs. each

**Package D:** wrench x 2 pcs.

**Please Note:** First time use, clean inside glass and wipe inside area with damp sponge. Thoroughly wipe inside of Stainless Steel Pot with clean damp sponge before heat is applied.



# ASSEMBLY PROCEDURE

1. Use (2) 9/16"x 1-3/8" bolts (Package B) provided to connect the Long Stand (A) and the 2 Square Poles (B) together.
2. Connect the assembly above (step 1) with the Short Stand (C) by using (2) 9/16"x 1-3/8" Bolts (Package B).
3. Add a Cap Nut and washer (Package C) to one end of the Axle (D). Insert Axle (D) through one wheel (E) and into Short Stand Axle hole (C). Place the second wheel (E) on the opposite end of Axle (D). Next place Cap Nut and Washer (Package C) onto the exposed end of the Axle (D). Tighten Cap Nut with wrench provided (P). Check Cap Nut tightness periodically during routine maintenance.

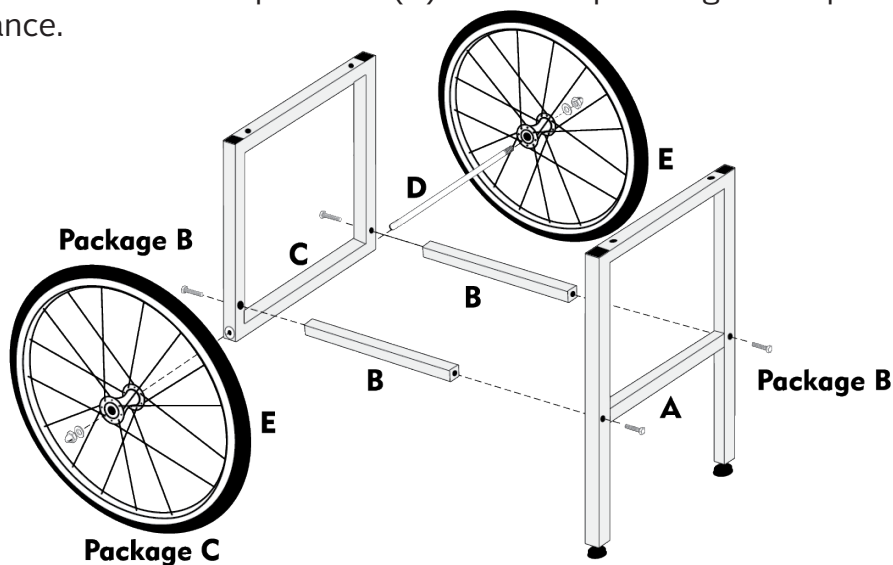

4. Install the Handrail (G) onto the right hand side of the storage unit (F) and the working platform (H) on the left hand side with the Nuts, Bolts and Washers included (Package A).

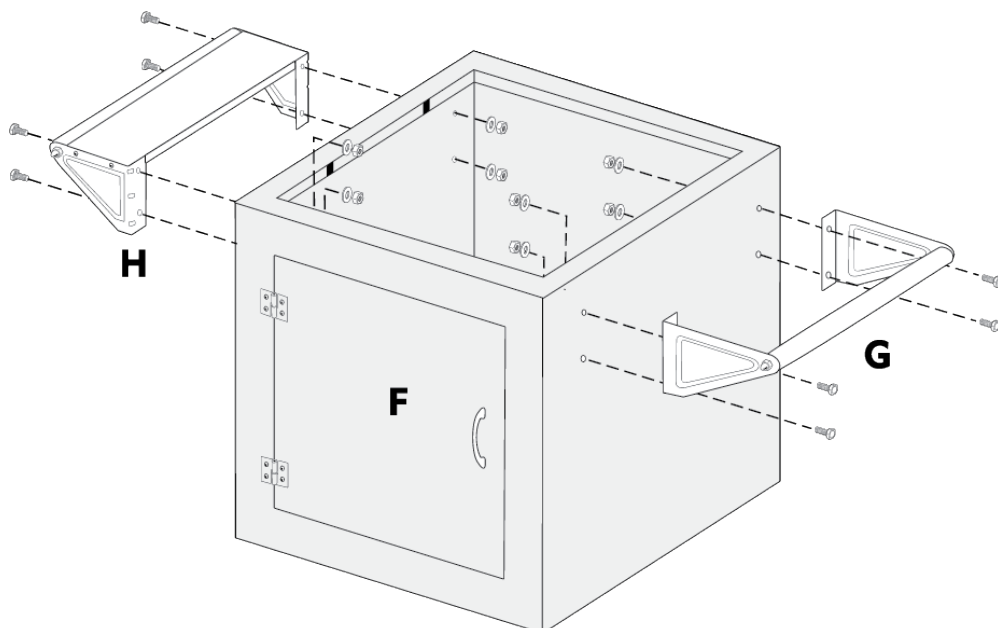

# ASSEMBLY PROCEDURE

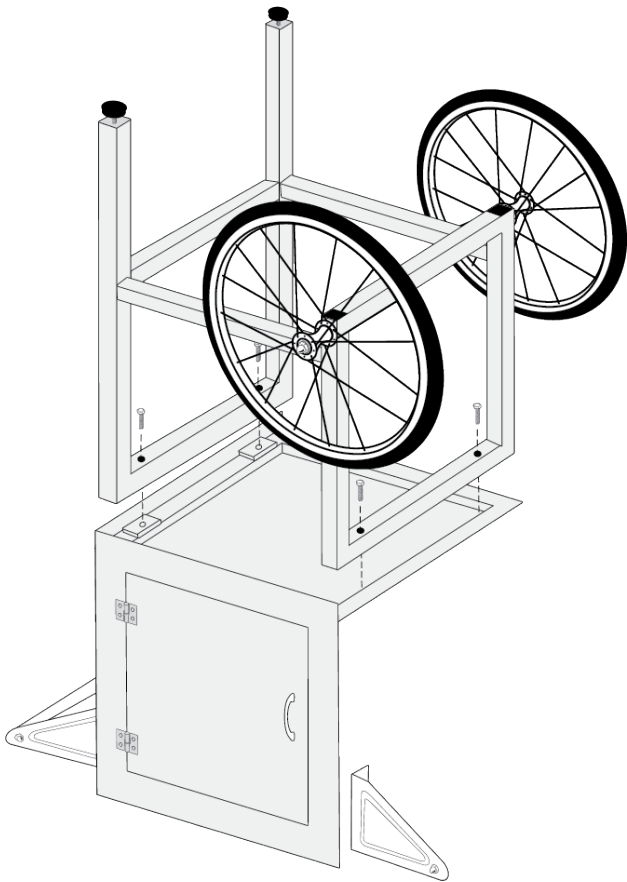

6. Place the main Popcorn Machine unit (1) onto the topside of the Storage Cabinet (F). Align the power cord located on the right side of the Popcorn Machine unit with the u-shape cut out on the right side of the Cabinet. Use the four spring loaded latches to secure the Popping Unit to the Storage Cabinet.

**Caution:** Do not attempt to move your Popcorn Machine without securing the latches. The Popping Unit will topple off causing property and/or personal damage.

5. Turn the Storage Cabinet (F) upside down for convenient assembly. Insert both ends of the Short and Long Stands onto the bottom of Cabinet (wheels opposite of the handle attachment) and attach with Bolts (Package B). Use the wrench provided to thoroughly tighten Bolts. Turn the completed unit back to an upright position.

**Note:** This task should be performed on carpet or a section of cardboard to avoid scraping the cabinet or damaging your floor. This is ideally a two person task.

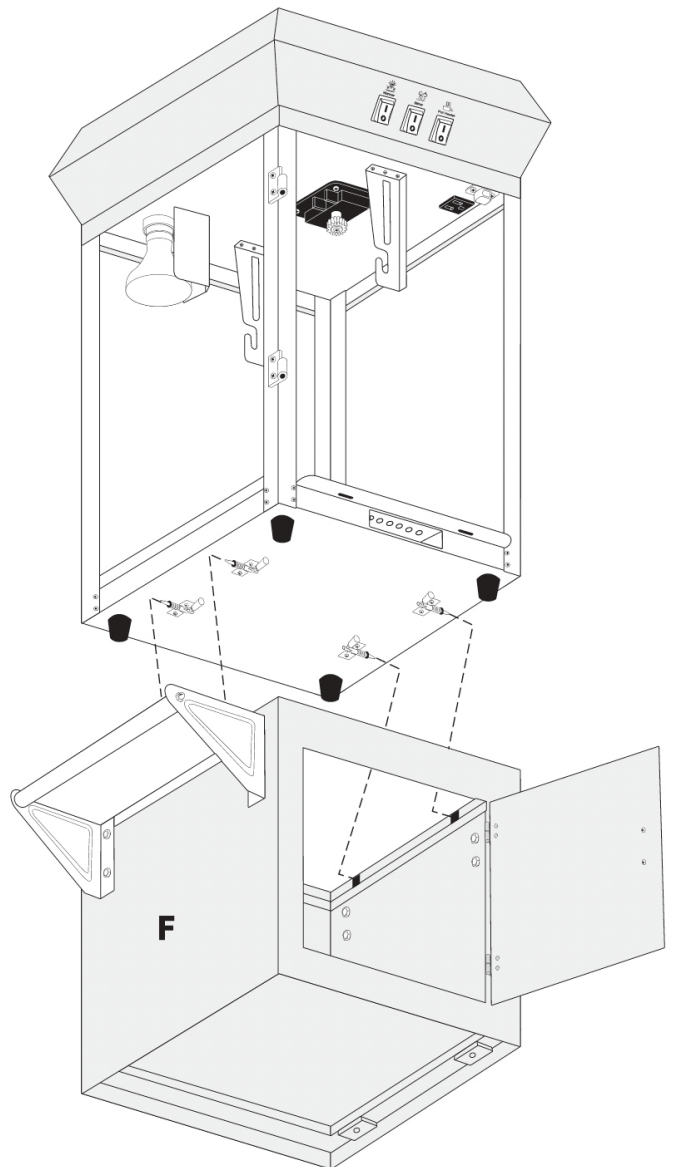

# ASSEMBLY PROCEDURE

7. The Glass Door (J) simply slides into the two anchor hinges on the Popping Unit. (I)  
The door is easy to remove for cleaning.

**Note:** The Metal Handle should align with the magnetic latch on the Popping Unit (I).

8. Align the two bottom tabs on the Stainless Steel Tilt Door (L) with the slots on the bottom platform of the Popping Unit. The side panels will bend in slightly to manoeuvre past the corner rails.

9. The "Old Maids" Drawer (M) slides into the opening at the bottom of the Popcorn Machine unit.

**Note:** The "Old Maids" drawer is designed to catch un-popped kernels that fall through the sized holes. Occasionally empty the drawer. Debris that may not make it into the drawer should be removed before replacing the drawer tray. Loose debris can prevent the drawer from shutting properly.

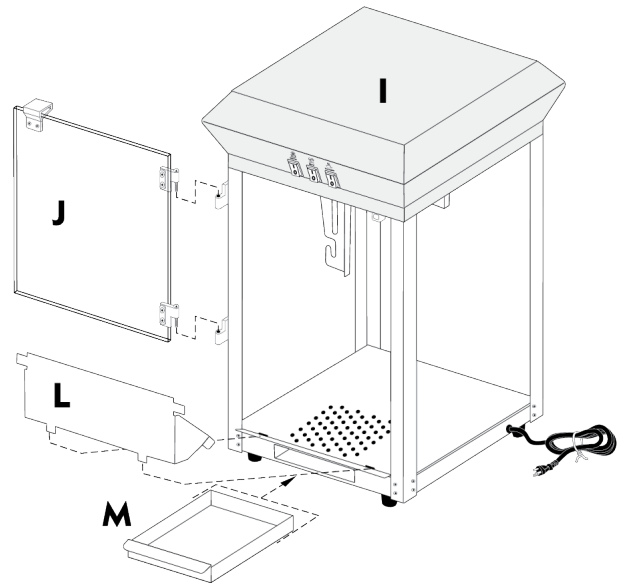

10. Next place the Pot (K) onto the Hangers located in the Popcorn Machine unit. Hold the pot cantered at approximately a 70 degree angle as illustrated here. Place the two Hanger Bars into the slots on the Hanger. **DO NOT** force. Make sure the Hangers are well seated before swinging the Axle Shaft up to the Motor. The Roller Pin will fit into the niche on the Motor and will help align the Gears. Check to make sure the Gears are properly meshed together before starting the Motor.

**Note:** The Hand Bar should be on the door facing you.

**CAUTION** The Pot on this Popcorn Machine will become extremely hot when in use.

**DO NOT** Remove or install Pot until it is completely cooled off.

**DO NOT** Load the Pot before installing or while hot. Avoid steam released from the Pot as it can scald and cause severe burns.

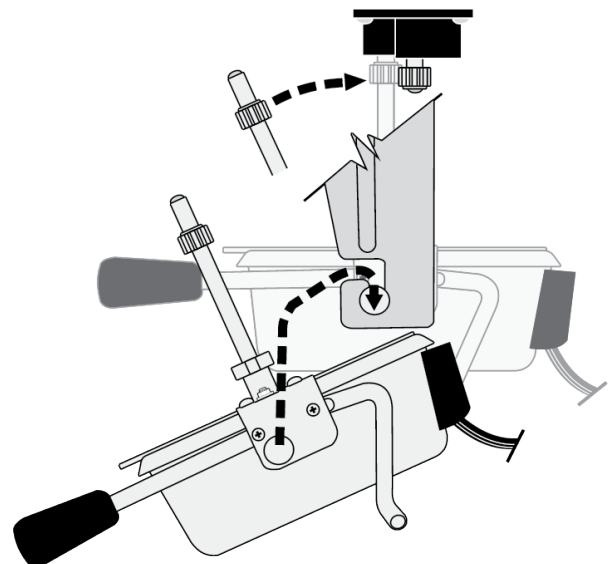

# ASSEMBLY PROCEDURE

11. The last step is to plug the Pot into the outlet located on the ceiling of the Popcorn Machine Cabinet. Before plugging the Pot into the Cabinet outlet, make sure the Pot is seated properly on the Hangers, the Gear Shaft is properly aligned and all the switches are in the off position.

**NEVER** plug the Pot cord directly into a electrical outlet.

**Note:** The Upper Cabinet is equipped with rubber feet and can be used separate from Storage Cabinet on a sturdy counter top.

**DO NOT** place the Popcorn Machine near a heat source such as a stove or oven. Allow a minimum of 12" of open space on all sides.

**DO NOT** place this unit near water or a water source.

**DO NOT** use electric circuits that do not meet minimum requirement as specified.

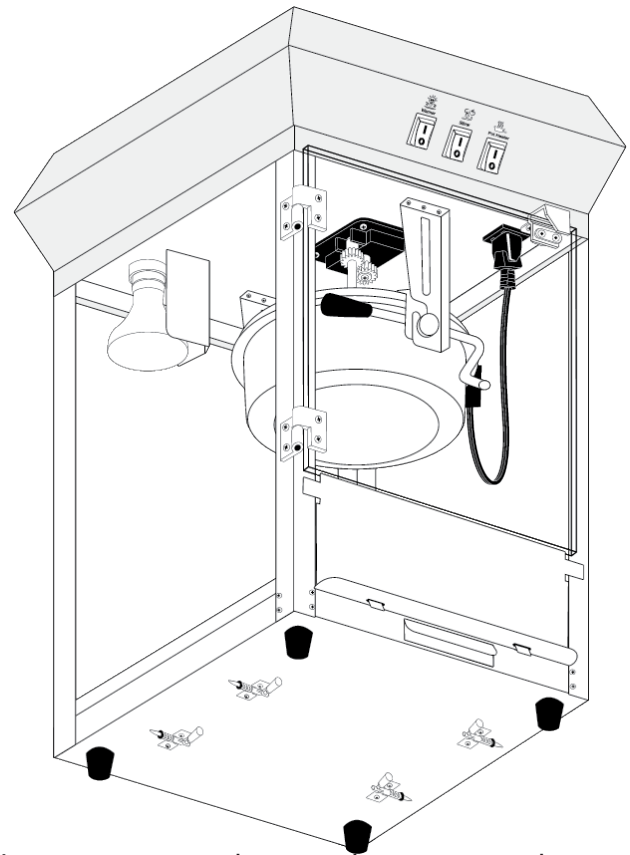

Now that you have assembled your Popcorn Machine, you are ready to make popcorn the way it's made in theaters and concessions everywhere. Below are instructions on how to operate your Popcorn Machine. Read them carefully to make yourself a popping expert. When operated correctly your Popcorn Machine will give you many years of service and happiness.

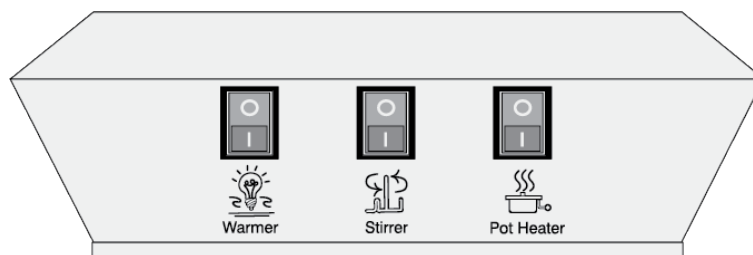

The **Warmer** switch operates the light in the back left corner of the Popcorn Machine unit and the Warming Element in the bottom tray. The Warmer can be left on for extended periods of time. The two elements work together to keep the popcorn fresh and warm. Ready to Eat!

**Warning:** Do not dump liquid toppings onto popped corn while in the Popcorn Machine. It will cause a huge mess and result in much clean-up time. Remove popcorn to a serving bowl before adding wet toppings.

The **Stirrer** switch operates the Stirrer located inside the Pot. Make sure it is free of obstruction and the Axle Gear and the Motor Gear are properly seated before turning the Stirrer switch on. If the Pot is not cleaned at appropriate intervals or recommended popping oils are not used, the bottom of the Pot will gum with burnt oil and debris. If the Stirrer sounds the least bit strained, switch off immediately and solve the problem.

The **Pot Heater** switch operates the Heating Element in the bottom of the Pot. (Kettle) It is engineered to deliver the perfect temperature for popping Popcorn. It is extremely hot!

Care should be taken when in close proximity of the Pot. When the Pot is hot use heat resistant gloves. Only touch the Safety Knob on the pouring handle.

# USING YOUR POPCORN MACHINE

It is important that the operator of this appliance should follow the instructions listed below carefully. Failure to do so may result in damage to your Popcorn Machine.

Before using the Popcorn Machine please ensure that the voltage is suitable for your country. The voltage should match the rating label specified next to the power cord.

Clean the internal surface of the **Kettle (B)**, and all the units surfaces, then hook the **Kettle (B)** onto the Hanger of the **Main Unit (A)**.

The **Main Unit (A)** has three different switches with three different functions.

1. Switch on the Light (Figure 1) in the **Main Unit (A)**.
2. Pour 2oz of oil into the **Kettle (B)** (Figure 4).
3. Pour 8oz of Popcorn kernels into the **Kettle (B)** and close the **Kettle (B)** Lid (Figure 5).
4. Switch on the Agitator and Heater (Figures 2&3).
5. The Agitator should begin to rotate (Figure 6).
6. Allow the oil to melt then add the correct measure (per instructions) of flavouring.
7. The Popcorn kernels should start to pop within a minute or two.
8. Popcorn will begin to spill out of the **Kettle (B)** onto the Heating Deck (Figure 7).
9. Switch off the Agitator and Heater (Figures 2&3) when the popping becomes less frequent.
10. Release the **Kettle (B)** from the Latch and pour the remaining Popcorn out of the **Kettle (B)** onto the Heating Deck.
11. Serve Popcorn with scoop provided.
12. Remove the plug from the power supply if the unit is not being used for a long time.
13. Repeat the above steps for more Popcorn.

Figure references 1 to 7

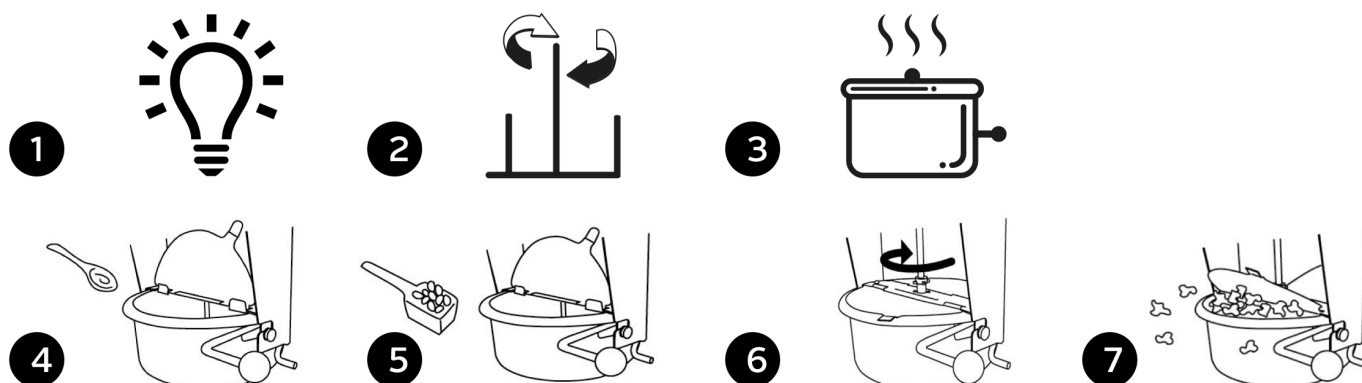

# MAINTENANCE AND CLEANING

Before cleaning your appliance please ensure that you have unplugged it from the mains supply and allowed it to cool down. read the general rules applicable to electrical equipment before taking any action on the appliance.

## THE FRAME

- Clean the Frame with a damp warm cloth and diluted liquid detergent.
- Never use abrasive products or metallic brushes.
- Do not clean the appliance under flowing water.
- Do not immerse the appliance.

## THE KETTLE

Disconnect the unit from the power supply and wait until the unit has cooled down before you begin with any maintenance or cleaning procedures. Food residues or spots on the surfaces have to be cleaned immediately (make sure not to burn yourself as the unit could still be hot) or at the latest before operation. Use a damp cloth for cleaning if only slight residue has to be removed. If this is not sufficient please wait until all parts of the unit have become cold and clean with an appropriate, non-abrasive, detergent. Never submerge the **Kettle (B)** in water.

Sephra would advise you to use **Heat'n'Kleen Kettle Cleaner**.

**Heat'n'Kleen** is safe and simple to use. Its outstanding detergency emulsifies grease and oil and will soften hard carbon deposits that build up within the **Kettle (B)** making it easy for removal. An 879g tub of **Heat'n'Kleen** will provide you with many **Kettle (B)** cleans.

Use 2oz of **Heat'n'Kleen** per gallon of water for moderate soils. For heavy duty cleaning up to 4 ounces may be used per gallon.



# SEPHRA<sup>®</sup>

CATERING EQUIPMENT AND SUPPLIES

Sephra Head Office - Sephra House, Denburn Road, Kirkcaldy, Fife, Scotland KY1 2BJ  
Tel: +44 (0)1592 656 737 / Fax: +44 (0)1592 653 535  
Web: [www.sephra.com](http://www.sephra.com) / Email: [info@sephra.com](mailto:info@sephra.com)

Sephra USA LLC - Tel: +1 858 675 3088 / Web: [www.sephrausa.com](http://www.sephrausa.com) / Email: [info@sephrausa.com](mailto:info@sephrausa.com)